

Setting up Microsoft Authenticator



1. Head to <https://mysignins.microsoft.com/security-info> and sign in using your Bryn Athyn College Microsoft 365 account.
2. Select **Add sign-in method**.

Security info

These are the methods you use to sign into your account or reset your password.

You're using the most advisable sign-in method where it applies.
Sign-in method when most advisable is unavailable: Microsoft Authenticator - notification [Change](#)

[+ Add sign-in method](#)

 Phone	<input type="text"/>	Change	Delete
 Password	Last updated: <input type="text"/>	Change	
 App password	BrynAthynEdu		Delete

3. Select **Microsoft Authenticator**.

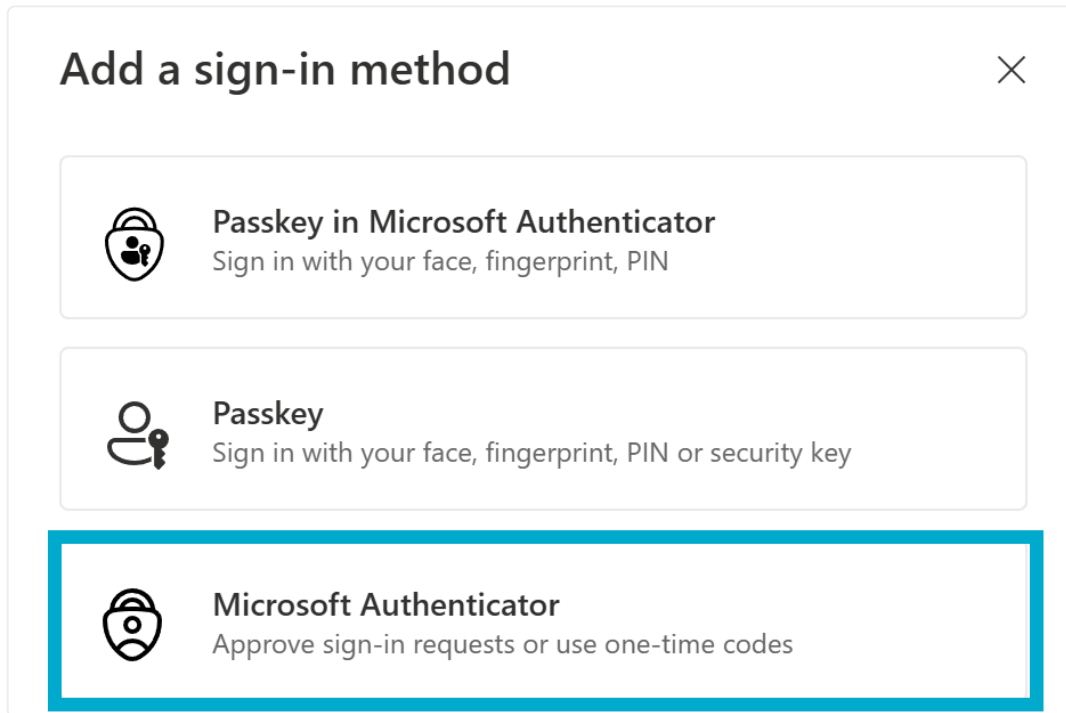

4. Download the Microsoft Authenticator app on your phone. It is available via the Apple App Store or the Google Play Store. Scan the QR code with your phone to get to the app store listing for your device.



5. Back on the Microsoft 365 account page, select **Next** on the prompt for the Microsoft Authenticator app.

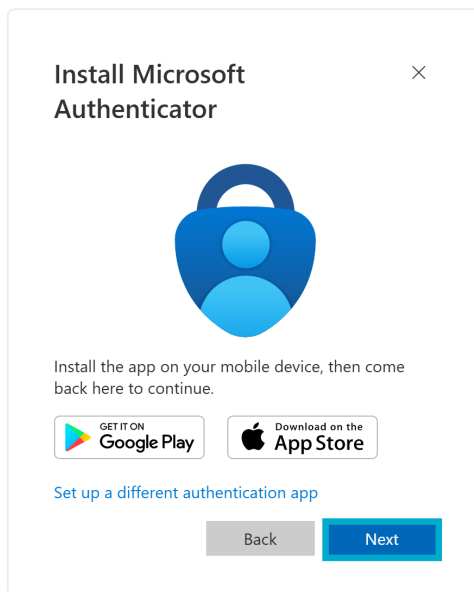

6. Remain on the **Set up your account** page while you set up the Microsoft Authenticator app on your phone.
7. Open the Microsoft Authenticator app. If prompted, select to allow notifications. Click the + in the top right.

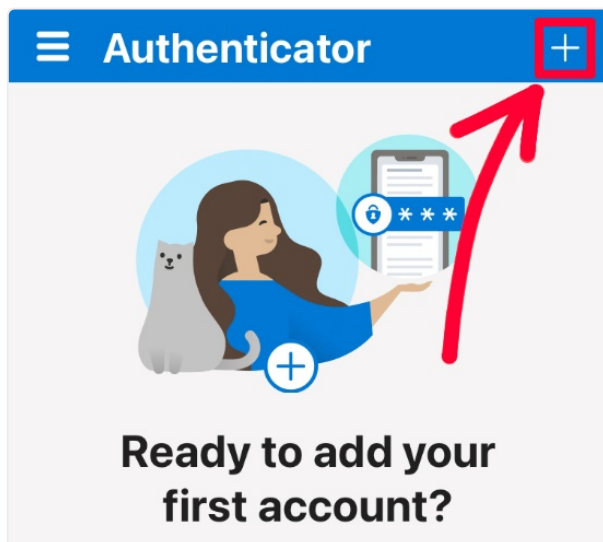

8. Select **Work or school account**.

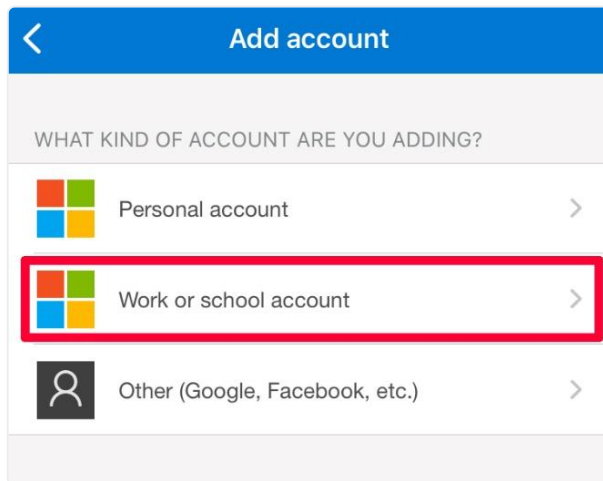

9. Go back to your browser page where you are signed into your account and select **Next** on the current prompt.

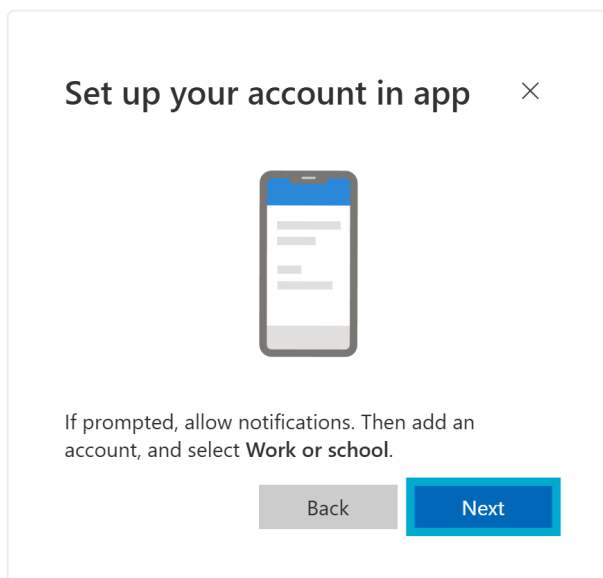

10. In Microsoft Authenticator, select **Scan QR code**, then scan the code on your computer.

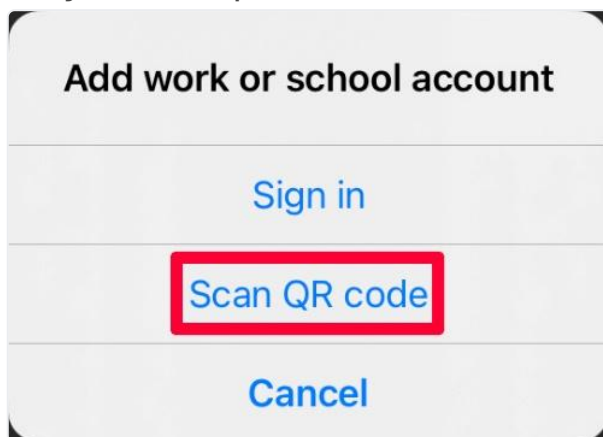

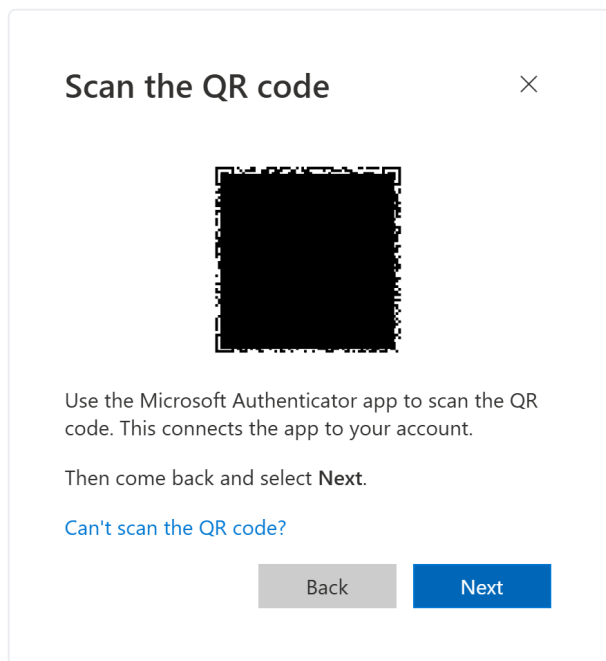

1. Your account should now be added to your authenticator app. To make sure everything is working, select Next in the panel with the QR code. This will send out a test MFA notification to confirm you are able to approve alerts for your account. After approving the MFA prompt select Next again to complete the process.

- L2. Set the Authenticator app as your default sign-in method. To do this, select the blue **change** option next to your current Default sign-in method near the top of the screen. From the drop-down list select Microsoft Authenticator - Notification, and then select confirm.

The image shows two screenshots from a user interface. The top screenshot is titled 'Security info' and contains the text 'These are the methods you use to sign into your account or reset your password.' Below this, there is a section for 'Default sign-in method: Phone - text +1' with a blue 'Change' button next to it. Below that is an 'Add method' button and a list of methods: 'Phone' with the number '+1 1234567890' and 'Microsoft Authenticator' with the code 'XX-XXXX'. The bottom screenshot is titled 'Change default method' and asks 'Which method would you like to use to sign in?'. It shows a dropdown menu with 'Microsoft Authenticator - notification' selected. Below the dropdown are three options: 'Phone - call +1', 'Phone - text +1', and 'Microsoft Authenticator - notification'. The 'Microsoft Authenticator - notification' option is highlighted with a red box.

Revision #9

Created 2026-06-03 13:28:26 UTC by Ian Kistner

Updated 2026-06-16 12:37:04 UTC by Ian Kistner